



CONTACT  
US FOR MORE  
DETAILS

**£500,000**

Lodge Farm Stables, Birmingham Road, Shenstone Wood End WS14 0LQ

**Plot with Planning permission for the erection of a new single storey dwelling.**

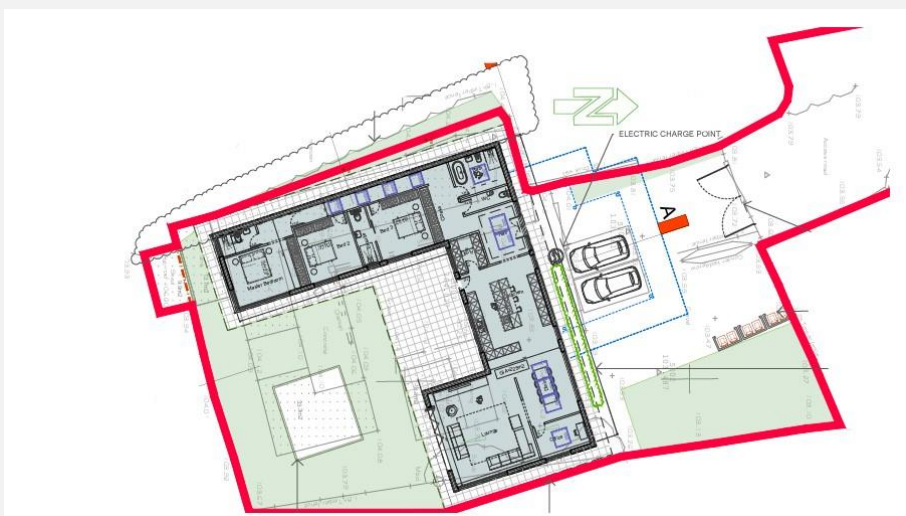

- Plot with detailed planning permission
- Lichfield Planning Ref: 22/01277/FUL
- ca. 2,442 ft<sup>2</sup>
- Plans available upon request
- Idyllic location between Lichfield and Sutton Coldfield
- Open Plan kitchen/living room
- Generous sized garden
- Parking to front
- Buyers Fees Applicable

Purchaser to be responsible for payment of the selling agents fees, 2% of the purchase price, plus VAT.  
Payable upon exchange of contracts.

Book your **viewing...**

**0121 353 9200**

[sales@paulcarrlandandnewhomes.co.uk](mailto:sales@paulcarrlandandnewhomes.co.uk)

With you  
every step  
of the way



Book your **viewing...**

**0121 353 9200**

[sales@paulcarrlandandnewhomes.co.uk](mailto:sales@paulcarrlandandnewhomes.co.uk)



**Agent's note:** Every care has been taken with the preparation of these Sales Particulars but they are for general guidance only and complete accuracy cannot be guaranteed. If there is any point which is of particular importance, professional verification should be sought. All areas, dimensions or distances are approximate. Photographs/images are reproduced for general information purposes only. It should not be assumed that the land has all necessary planning, building regulations or other consents. Purchasers should undergo their own investigations with regard to services. These Sales Particulars do not constitute a contract or part of a contract.

**Tenure:** We understand that the land is Freehold.  
Any plans or aerial photographs/images provided with these particulars are for identification purposes only and their accuracy is not guaranteed.  
The land is sold subject to, or with the benefit of any rights of wayleaves, easements, restrictive covenants etc. which may exist whether mentioned in these particulars or not.  
Prospective purchasers must undertake their own investigations with regard to ground conditions and fully satisfy themselves as to the suitability of the site.

**PLEASE NOTE: Under the terms of Estate Agents Act 1979, Paul Carr Estate Agents disclose a personal interest in this development.**